



emli Not

Important Note:

"Screwing NPT thread is not recommended to avoid cracking problems because of male nipples are heat-treated and are in BSP thread size."



FF SERIES HYDRAULIC FLAT FACE QUICK COUPLINGS

FF Series Hydraulic Flat Face Quick Couplings are specially designed for easy cleaning and preventing the penetration of contamination to the hydraulic circuits.

Male nipples of FF Series are hardened by heat treatment.

Manual sleeve locking mechanism prevents accidental and involuntary connection & disconnection.

The main fields of application for FF Series are environment-sensitive areas and hydraulic tools.

Interchangeability	ISO 16028
Shut-off System	Flat Valve
Material	Carbon Steel
Thread Size	BSP (Upon Request: NPT, Metric)
Sealing	Nitrile O-ring (NBR)
Working Temperature	-30 °C and +110 °C
Plating	Zinc Plating (Cr III Passivation)
Heat Treatment	Male nipple
Connection System	Pulling back the sleeve
Disconnection System	Pulling back the sleeve
Connection Under Pressure	Not Allowed
Disconnection Under Pressure	Not Allowed
Upon Request	VITON & High temperature resistant special spring (-30 °C & +225 °C), Polyurethane (PU)
Applications	Construction, production, national defense, aviation, mobile hydraulic, chemical, mining



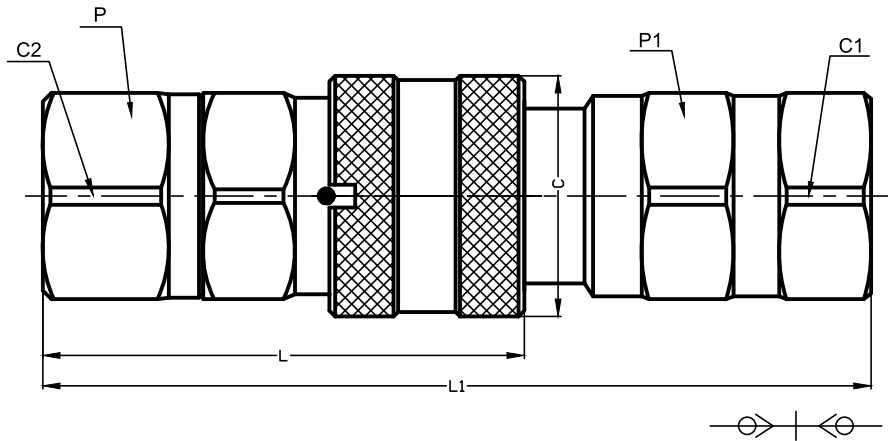

Technical Specifications

(Code)	(Thread Size)	(Working Pressure) Bar	(Dimensions) - mm							
			C	C1	C2	L	L1	P	P1	
FFG14SN	1/4" BSP	380	28	24.50	27	66	99.50	24	22	
FFG38SN	3/8" BSP	350	32	30	30	79	125.50	27	27	
FFG12SN	1/2" BSP	350	32	30	30	79	125.50	27	27	
FFG34SN	3/4" BSP	350	42	40	40	90	151	36	36	
FFG1SN	1" BSP	330	47.50	46	46	105.50	179	41	41	

Flow Rate / Pressure Drop Table

(Code)	(Thread Size)	(Pressure Drop) - Δ p		
		1 Bar	2 Bar	5 Bar
FFG14SN	1/4" BSP	14	20	40
FFG38SN	3/8" BSP	28	45	75
FFG12SN	1/2" BSP	55	75	135
FFG34SN	3/4" BSP	120	160	250
FFG1SN	1" BSP	145	200	350

